



All-new for 2018, the Newmarket is a stylish and affordable addition to the range with a contemporary, semi open-plan living space and Omar's hallmark of quality.

The simple yet stylish exterior benefits from tall windows to the front of the home, allowing plenty of natural light in and French doors to the lounge area; a lovely feature for those long summer days.

Inside you immediately get a feeling of openness with a large, contemporary styled, semi-open plan living space.

- **New detached single-storey turn-key homes**
- **Fully fitted kitchen with integrated appliances**
- **10 Year Gold Shield Warranty**
- **2 double bedrooms and 2 luxury bathrooms**
- **100% part exchange offered against your home**
- **No chain - move straight in**

## YOUR BRAND NEW HOME AWAITS

Release equity from your old home  
Ask one of our Sales Advisers about Part Exchange



PRESTHOPE GRANGE  
RESIDENTIAL PARK HOMES



PART EXCHANGE  
YOUR HOME



**CONTACT US TODAY TO FIND OUT MORE INFORMATION OR TO ARRANGE A VIEWING**



## 50' x 20' - 2 Double Bedrooms, 2 Bathrooms

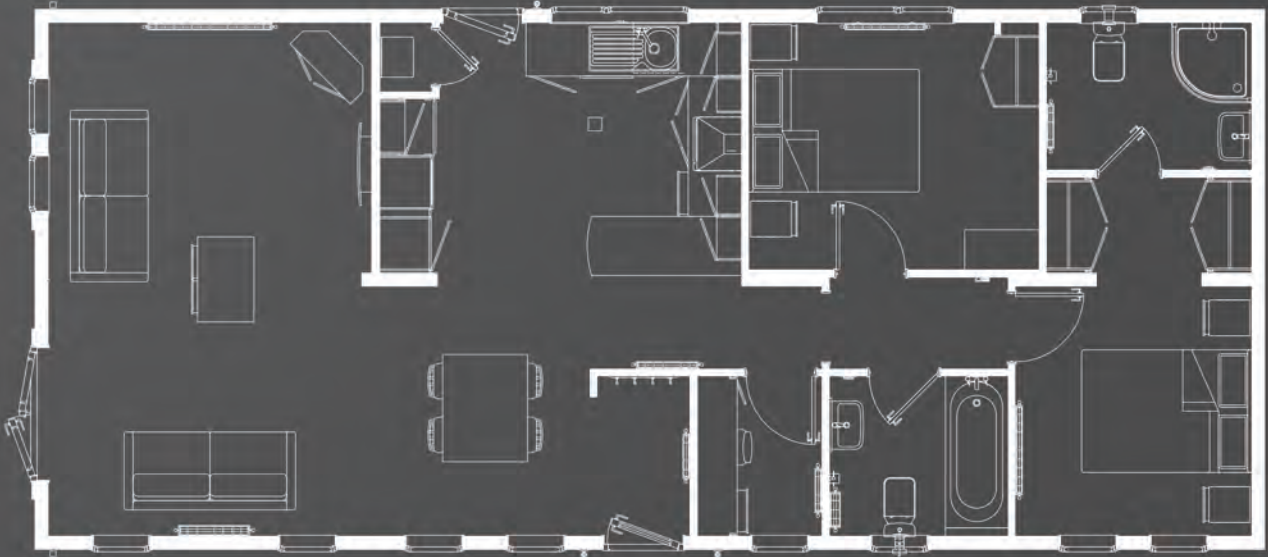

## 40' x 20' - 2 Double Bedrooms, 2 Bathrooms



A spacious ivory fitted kitchen with integrated appliances provides a wonderful contemporary and bright environment for making family meals and a large breakfast bar means that it's a sociable space too. The master bedroom with its soft, soothing colour palette has two double wardrobes and freestanding bedside cabinets, providing plenty of storage space and the en-suite shower room, which is situated beyond the dressing area, is contemporary and sleek. If you're looking for a quality, affordable home with contemporary styling and a touch of luxury, this may well be the home you've been looking for!

### YOUR BRAND NEW HOME AWAITS

Release equity from your old home  
Ask one of our Sales Advisers about Part Exchange



PRESTHOPE GRANGE  
RESIDENTIAL PARK HOMES



PART EXCHANGE  
YOUR HOME



**CONTACT US TODAY** TO FIND OUT MORE INFORMATION OR TO ARRANGE A VIEWING